

AURA

ERO 540 MKII

RGB LED movinghead



User manual

Any information and illustrations shown in this user manual are subject to change without further notice.

User manual version: 2.0 Creation date + author initials: 03-01-2014 RV Revision date + author initials: 28-07-2014 RV

Safety instructions



WARNING!



Always keep this device away from moisture and rain! Hazardous electrical shocks may occur!



WARNING!



Only connect this device to a matching power outlet. This device is intended to work on a specified AC currency. Connecting this device to power outlets with other voltages may result in permanent damage and possible hazardous situations, such as fire or electrical shocks!



WARNING!



Be careful with every operation of this device. Touching live wires inside and outside the unit may cause hazardous electrical shocks!

This unit must be operated by, or under the supervision of an adult. This device is not suitable for children.

Every person involved with the installation, operation and maintenance of this device has to:

- Be qualified
- Follow the instructions of this manual
- Make sure there is no damage caused by transport. If the device seems damaged from the outside, do not use it and contact your dealer for more information and consultation.
- To make sure the device maintains in perfect condition and for safe operation, it is necessary for the user to follow the instructions and warning notes of this user manual.
- Damage caused by improper use or modifications to the device are not covered by warranty.
- This device does not have any user-serviceable parts inside. Servicing of this device needs to be done by qualified technicians.

Important notes regarding safety and health:

- Never let the power cord come in contact with other cables. Handle the power cord and all connectors with the mains with caution.
- Never remove any warning or informative labels from the unit
- The ground contact always needs to be connected. Do not cover or remove the ground contact.
- Never leave cables lying around
- Do not open the device and do not modify any hard- or software of this unit.
- Do not insert this object into air vents.
- Do not connect this device to a dimmerpack.
- Do not switch the system on and off frequently as this will reduce the lifespan of the device.
- Do not drive the inputs of the fixture with a signal larger than required to work at full performance.
- Only use this device indoor, avoid contact with water, moist or other liquids. Do not place items filled with liquids on top of the unit.

Any information and illustrations shown in this user manual are subject to change without further notice.

User manual version: 2.0 Creation date + author initials: 03-01-2014 RV Revision date + author initials: 28-07-2014 RV

- Avoid nearby flames or heat sources, do not place this device near flammable liquids, gas or flammable items.
- Always disconnect the device when it is not in use for a longer period or time, when servicing is needed or when the device needs cleaning.
- Only handle the power cord by its connectors. Never pull the cable to remove a connector from its socket, as this could lead to damage and electrical shocks.
- Always operate this device with a stable AC current.
- Always operate this device with the AC ground wire connected to the electrical system's ground.
- Never use other types of cables than specified in the manual, do not use defective or bad functioning cables. Contact your dealer when the included or required cables do not work properly with this device.
- When the device has been exposed to large temperature differences (for example, transport from outdoor to indoor), do not connect the device immediately. Do not activate the unit until it has reached room temperature, as moist might build up inside the unit, which may cause shortcuts and/or electrical shocks.

Guidelines and types of use:

- This device is intended to be used by professionals on stage, in theaters, clubs and other equal venues.
- This device is not suitable for children and always needs to be operated by an adult.
- Only use the device when the environment is suitable and will not cause any damage. Do not use the product in moist or dusty environments, or where long-term damage may occur such as:
 - indoor swimming pools where chlorine is used.
 - Beaches, where sand and salt are present.
 - Outdoor, without roof protection
 - Indoor areas where intense heat sources are present or where the temperature exceeds levels which are comfortable for humans.
- Only use the included power adapter and only connect the device to a suitable power outlet with the correct output voltage. Connecting the device to a power outlet with the wrong type of voltage or using the product with a wrong type of power supply may cause permanent damage to the device.
- Avoid shocks and collision during use and transport. Do not transport the device while in use. Avoid brute force during the installation and operation of this device.
- Familiarize yourself with the functions of the device before use. Do not allow operation of the device by unskilled or unqualified people.
- Use of the device in other ways than described in this user manual may cause damage and injury. Ayra can not be held responsible for any damage or injury caused by improper use.

Storage and transport:

- This device is intended for mobile use. When transported, use the original packaging of the product, or a fitting flightcase, preferably filled with foam.
- This device is not intended for permanent use. Operation breaks will ensure that the lifespan of the device remains unchanged.
- If the device is not used for a longer period of time, disconnect it from its power source and store it in its original packaging, or in a fitting flightcase.
- Store the device indoor, dry and do not expose the device to extreme temperature differences.

Housing:

- Inspect the housing of the device frequently. Severe dents, cracks and missing screws should be avoided at all costs. Do not use the device when the housing is not in optimal condition. Contact your dealer or a skilled technician when in doubt about the state of the device
- Check the fixture and screws for corrosion. Corrosion should not be present on the fixture. Contact your dealer or a skilled technician when corrosion is found on the fixture
- Every power or signal chassis/connector should be mounted tightly. Do not use the device when connectors are loose.
- Do not use the power cord when the cores are visible. Contact your dealer for a replacement if needed.
- Avoid the buildup of dust and dirt. Clean the exterior of the fixture every month with a dry or damp cloth. When using the device intensively, the cleaning frequency needs to be increased.

Fuses:

- The main fuse of this device is to be found on the rear of the device. In most cases, directly next to the power inlet.
- Only replace a fuse for a new one with the same type and rating! Do not use a fuse with a higher or lower

Any information and illustrations shown in this user manual are subject to change without further notice.

User manual version: 2.0 Creation date + author initials: 03-01-2014 RV Revision date + author initials: 28-07-2014 RV

rating.

- Do not bridge the fuse with electrical wires, aluminum foil, as the fuse is used for protection against electrical shocks and short circuit.
- Always mount the fuse cover back to the fuse compartment.

ALURA

Any information and illustrations shown in this user manual are subject to change without further notice.

User manual version: 2.0 Creation date + author initials: 03-01-2014 RV Revision date + author initials: 28-07-2014 RV

Box contents

Box contents

1x ERO 540 MKII movinghead
1x power cable to Schuko
1x installing bracket
1x small bag with mounting hardware

Unit and accessory inspection

- Always use the supplied power cable to connect the unit to a power supply. If the cable appears broken or has visible damage, do not use it.
- If the unit is not going to be used for a longer period of time, disconnect it from the power supply and store it in a dust-free environment.
- Always check the unit for possible damage before use. If you suspect that something is wrong with the unit, do not connect it to a power source! When you suspect that your unit is broken or damaged, contact your local dealer or a certified technician to inspect the unit.
- When your device does not generate any light, do not look directly into the lens. When the fixture suddenly produces a beam, it may cause injury to your eyes.

ALURA

Any information and illustrations shown in this user manual are subject to change without further notice.

User manual version: 2.0 Creation date + author initials: 03-01-2014 RV Revision date + author initials: 28-07-2014 RV

Device overview



1. Beam output
2. Control panel with display and menu-functions
3. Adjustable manual focus
4. Cooling fan head
5. IEC power inlet
6. DMX input
7. DMX output
8. Safety eye

This unit is equipped with an adjustable focus, which makes it possible to sharpen the beam when used at a small or large distance.

Any information and illustrations shown in this user manual are subject to change without further notice.

User manual version: 2.0 Creation date + author initials: 03-01-2014 RV Revision date + author initials: 28-07-2014 RV

Setting up the device

To activate the unit, connect the included power supply to the unit and a suitable 230V, 50 Hz power outlet. The unit will activate directly after it is plugged in to a wall outlet or other power source.

Give the movinghead time to calibrate the stepping motors, which are used to determine the position of the head. You may hear and see some shaking, which is normal. The stepping motors use an end point to determine the beginning and end of their movement. The display shows the current status. After calibration, the movinghead will start the previously used mode, but by default it is usually set to DMX mode.

The status of the movinghead is shown on the display (which automatically shuts off after a few seconds of inactivity). The shown values determine the current status and can be changed by pressing the buttons on the control panel. The four buttons each have their own function, for easy navigation.

Press the 'ESC' button to switch modes, so you can easily select the built-in automatic, music controlled or DMX mode.

The several operation modes and settings are set by using the buttons beneath the display. The following codes represent the different features:

Mode 1: d001 – d512 (DMX mode)

d001 is set as the default DMX address, it is possible to select a value between 001 and 512. Press Enter to confirm the new set address.

Mode 2: nStA / nStS / SLAv

- nStA: Master auto mode
- nStS: Master music controlled mode
- SLAv: Slave mode

Select the right mode by using the up and down buttons, press Enter to confirm.

To let the fixtures work in master/slave mode, connect several fixtures with standard XLR male – female cable. Set the first fixture in line to 'Master' (sound activated or automatic) and the following fixtures to 'Slave'. The slaves will mimic the signal of the master unit. It is possible to invert the pan and tilt modes for all connected slaves separately, for synchronized shows.

Mode 3: Pan / rPan

The default setting is a normal pan mode, but it is possible to invert the pan values internally. This way, several fixtures can be set to the same mode, but the movement of pan can be inverted for synchronized shows. rPan inverts the values. Press Enter to confirm.

Mode 4: tiL / rtiL

The default setting is a normal tilt mode, but as stated above it is possible to invert the values for synchronized shows. Press Enter to confirm.

Mode 5: dls / rdls

The default setting is a normal shown display, but when installing the fixture upside down (for example, in a truss system), you may wish to invert the display character mode. This way, it is easier to read the several statuses. Press Enter to confirm.

DMX mode

After calibration the display shows 'D001', which indicates that the unit is currently on DMX-mode, with DMX-channel 1 as the starting address. A small LED next to the last digit states whether the unit is receiving DMX.

Changing the DMX starting address is done by pressing the 'up' and 'down' buttons on the control panel. You can select a value between 1 and 512.

Any information and illustrations shown in this user manual are subject to change without further notice.

User manual version: 2.0 Creation date + author initials: 03-01-2014 RV Revision date + author initials: 28-07-2014 RV

The ERO 540 has two DMX modes, one for basic control (5 channels), the other for extended control (13 channels).

The following table shows the DMX charts, with the several channels and a function for each channel.

5-CH DMX mode	DMX values	Description
1	0 – 255	Pan
2	0 – 255	Tilt
3	0 – 7: Shutter closed 8 – 134: Dimmer 0-100% 135 – 239: Strobe slow-fast 240 – 255: Shutter open	Dimmer/Shutter
4	0 – 127: Color macro 128 – 256: Clockwise and counter-clockwise rainbow feature	Color
5	0 – 127: Gobo selection 128 – 191: Clockwise gobo scroll 192 – 255: Counter-clockwise scroll	Gobo

13-CH DMX mode	DMX values	Description
1	0 – 255	Pan
2	0 – 255	Pan fine
3	0 – 255	Tilt
4	0 – 255	Tilt fine
5	0 – 255: Fast – Slow	Pan and tilt speed adjustment
6	0 – 7: Shutter closed 8 – 134: Dimmer 0-100% 135 – 239: Strobe slow-fast 240 – 255: Shutter open	Dimmer/Shutter
7	0 – 255: 0-100%	Red
8	0 – 255: 0-100%	Green
9	0 – 255: 0-100%	Blue
10	0 – 255: 0-100%	Color macro
11	0 – 255: Slow – Fast	Color macro speed adjustment
12	0 – 127: Auto mode 128 – 255: Sound controlled mode	Working mode
13	0 – 12: Gobo 1 13 – 25: Gobo 2 26 – 38: Gobo 3 39 – 51: Gobo 4 52 – 65: Gobo 5 66 – 77: Gobo 6 78 – 90: Gobo 7 91 – 103: Gobo 8 104 – 116: Gobo 9 117 – 127: Gobo 10 128 – 191: Clockwise gobo scroll 192 – 255: Counter-clockwise scroll	Gobo

Any information and illustrations shown in this user manual are subject to change without further notice.

User manual version: 2.0 Creation date + author initials: 03-01-2014 RV Revision date + author initials: 28-07-2014 RV

Additional information

Mounting the bracket

On the bottom of the movinghead, there are two holes to mount the included bracket, using the included bolts. It is possible to mount a G-clamp or halfcoupler to this bracket. It is also possible to mount the bracket on a ceiling, wall, bar, floor, desk or any flat surface. The device may be installed standing up or in a hanging (vertical) position. Use proper equipment to install this fixture, as a dropping fixture may cause severe injury! Ayra can not be held responsible for any damage or injuries caused by improper installation.

Focus

The ERO 540 MKII movinghead is equipped with an adjustable focus system. This focus system is positioned directly below the lens and makes it possible to sharpen the projection of gobos and spot figures.

To adjust the focus for optimal projection results, you need a Phillips screwdriver. Only adjust the focus of the movinghead when it is positioned in a static position (disconnected from the power supply or via DMX in a static position).

Always support the head with your hand when tightening or loosening the screw for the focus system. Do not touch the lens as this may cause fingerprints and negative influences on the output.

Loosen the screw with the screwdriver, until you are able to move the focus back and forth. Avoid loosening the screw too much as it is spring loaded. Choose the right position for the focus and after that, tighten it again to fixate the focus in the current position.

See the images below for more information.

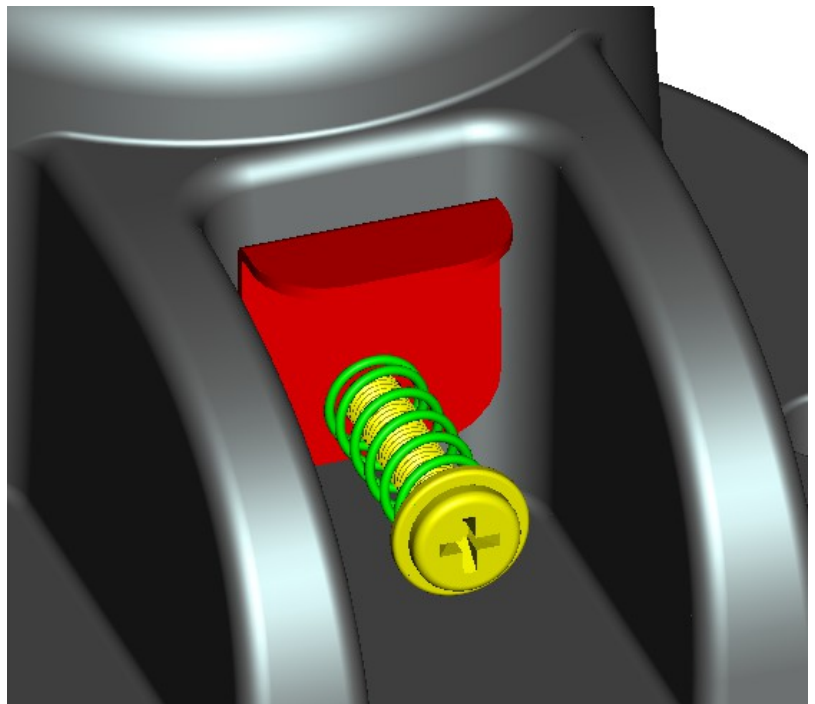

Any information and illustrations shown in this user manual are subject to change without further notice.

User manual version: 2.0 Creation date + author initials: 03-01-2014 RV Revision date + author initials: 28-07-2014 RV

DMX lighting troubleshooting

If you have any problems with DMX lighting, consult this troubleshooting section to solve any difficulties with your product. If this troubleshooting section does not solve your problem, contact your dealer for more information and help.

This troubleshooting section contains the most frequent problems and is not a complete collection of possible faults, defects and solutions. The troubleshooting section applies for DMX controllers, DMX cabling and DMX lighting fixtures. It is possible that not all described problems, causes and solutions apply to your situation as product details may vary from product to product.

Problem	Possible Cause	Solution
The fixture does not activate itself	Blown fuse	Check the fuse compartment for blown fuses and replace it if necessary.
	No power cable plugged in	Plug in the power supply to a matching power outlet
	Power switch is not in the ON position	Turn on the device by switching the ON/OFF switch to the ON position, if available
The fixture does not respond to DMX signals	Wrong DMX address	Set the DMX address to the right value
	DMX controller blackout function activated	Deactivate the blackout function of your DMX controller
	Faulty positioning of the DMX polarity switch on the controller	flip the polarity switch on your DMX controller
	No response or DMX activity signal LEDs active	Check your DMX cables for possible connection breaks and replace them if necessary.
The fixture does not respond to sound	Wrong working mode selected.	Check if the sound activated mode of the fixture is activated.
	Microphone sensitivity level is set too low	Increase the microphone sensitivity of the built-in microphone
	Speaker placed too far away or lack of bass	Place your lighting effect closer to your speakers (or vice versa) and/or increase low frequency volumes. The microphone will not be triggered with high pitched sounds.
The beam output is very low	Dirty/dusty optics	Clean the lens and/or other optics with a dry or damp cloth
	Dimmer is not set to full output	Set all dimmer levels to 100% on your DMX console
Sometimes the DMX signal is lost and/or some fixtures are flickering / behaving odd sometimes	Faulty/broken DMX cables	Check your DMX cables for possible connection breaks and replace them if necessary.
	Power cable interference on your	Avoid installing the DMX and

Any information and illustrations shown in this user manual are subject to change without further notice.

User manual version: 2.0 Creation date + author initials: 03-01-2014 RV Revision date + author initials: 28-07-2014 RV

	DMX signal	(high) power cables parallel to each other.
	No DMX terminator	Apply a DMX terminator at the end of your DMX-chain
	Signal loss or distortion in DMX values	Apply a DMX booster in your DMX chain after 32 fixtures or less. After a maximum of 32 fixtures the DMX signal needs to be refreshed.
Moving parts are not functioning well, values do not match and/or rattling sounds are noticed	Faulty stepping motor positioning	Possible value loss of stepping motors. Activate the reset function, or unplug the power supply and plug it back in to activate the reset program. This will reset all values to the original 0-point.
The fixture does not respond fast enough to the set speed on my DMX controller	Moving parts can not keep up with the set speed	Decrease the chase speed of your DMX controller, as the stepping motors of your fixture need some time to move from one point to another.
The fixture does not respond to all DMX-channels	Wrong DMX channel mode	Check the DMX channel mode of the fixture. If the wrong value is set, change the channel mode to a different setting and try again.

ALURA

Any information and illustrations shown in this user manual are subject to change without further notice.

User manual version: 2.0 Creation date + author initials: 03-01-2014 RV Revision date + author initials: 28-07-2014 RV

Technical specifications

- Compact movinghead using a RGB LED light source
- Light source: 15 Watt RGB LED chip
- Lifespan LED module: +/- 50.000 h
- Pan range: 540 degrees max.
- Tilt range: 270 degrees max.
- Modes: stand-alone, music controlled, master/slave, DMX
- Built-in stand-alone programs
- Built-in music controlled programs
- DMX-control with 5 or 13 DMX-channels
- Gobowheel: 9 gobo's + open
- Variable electronic strobe function (slow-fast)
- Electronic dimmer: 0-100%
- Beam angle: 13 degrees
- Maximum ambient temperature: 40 degrees Celsius
- Maximum housing temperature: 55 degrees Celsius
- Minimum distance from flammable surfaces: 0.5 m
- Power consumption: 60W max.
- Fuse: 1A 250V 20mm glass fast blow
- Power supply: 110-240V AC, 50/60Hz
- Measurements: 175 x 175 x 250 mm (without bracket)
- Weight: 5 kg

Connectors:

- DMX: 3p XLR male and female
- Power: IEC power connector

Included accessories:

- Power cable to Schuko
- Mounting bracket with allen bolts



Connectors and wiring schematics:

DMX-connections:

DMX-output

XLR mounting-socket:



- 1: Ground
- 2: Signal (-)
- 3: Signal (+)

DMX-input

XLR mounting-plug:



- 1: Ground
- 2: Signal (-)
- 3: Signal (+)

Electrical wiring:

Cable	Pin	International
Brown	Live	L
Blue	Neutral	N
Yellow/Green	Earth	

Any information and illustrations shown in this user manual are subject to change without further notice.

User manual version: 2.0 Creation date + author initials: 03-01-2014 RV Revision date + author initials: 28-07-2014 RV